

Vrtáky ze slinutého karbidu

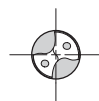

Y-TECH™ YPL Vrtáky s vnitřním chlazením

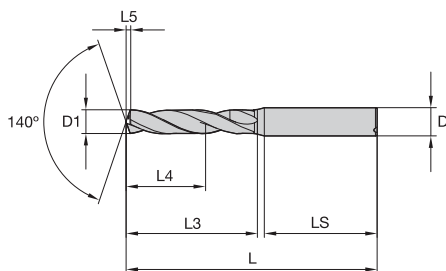

- První volba
- náhradní volba

H	
S	●
N	
K	
M	●
P	

B291_YPL

	D1			Objednací číslo	Katalogové číslo	D	L	L3	L4 max	L5	LS	KC7315
	mm	palce	palce									
VRTÁNÍ	3,000	—	.1181	3640677	B291A03000YPL	6	62	20	14	0,6	36	●
	4,000	—	.1575	3640678	B291A04000YPL	6	66	24	17	0,8	36	●
	4,500	—	.1772	3640679	B291A04500YPL	6	66	24	17	0,9	36	●
	5,000	—	.1969	3640680	B291A05000YPL	6	66	28	20	1,0	36	●
	5,100	—	.2008	3640681	B291A05100YPL	6	66	28	20	1,0	36	●
	5,500	—	.2165	3640682	B291A05500YPL	6	66	28	20	1,1	36	●
	6,000	—	.2362	3640703	B291A06000YPL	6	66	28	20	1,2	36	●
	6,350	1/4	.2500	3640704	B291A06350YPL	8	79	34	24	1,2	36	●
	6,500	—	.2559	3640705	B291A06500YPL	8	79	34	24	1,3	36	●
	6,800	—	.2677	3640706	B291A06800YPL	8	79	34	24	1,3	36	●
FRÉZOVACÍ NÁSTROJE	7,000	—	.2756	3640707	B291A07000YPL	8	79	34	24	1,4	36	●
	7,200	—	.2835	3668057	B291A07200YPL	8	79	41	29	1,4	36	●
	7,500	—	.2953	3640708	B291A07500YPL	8	79	41	29	1,4	36	●
	8,000	—	.3150	3640709	B291A08000YPL	8	79	41	29	1,5	36	●
	8,330	—	.3280	3640710	B291A08334YPL	10	89	47	35	1,6	40	●
	8,500	—	.3346	3640711	B291A08500YPL	10	89	47	35	1,6	40	●
	9,000	—	.3543	3640712	B291A09000YPL	10	89	47	35	1,7	40	●
	9,500	—	.3740	3640713	B291A09500YPL	10	89	47	35	1,8	40	●
	9,520	—	.3748	3640714	B291A09525YPL	10	89	47	35	1,8	40	●
	10,000	—	.3937	3640715	B291A10000YPL	10	89	47	35	1,9	40	●
KARBIDOVÉ STOPKOVÉ FRÉZY	10,320	—	.4063	3640716	B291A10320YPL	12	102	55	40	2,0	45	●
	10,500	—	.4134	3640717	B291A10500YPL	12	102	55	40	2,0	45	●
	11,000	—	.4331	3640718	B291A11000YPL	12	102	55	40	2,1	45	●
	11,500	—	.4528	3640719	B291A11500YPL	12	102	55	40	2,2	45	●
	12,000	—	.4724	3640720	B291A12000YPL	12	102	55	40	2,3	45	●
	12,500	—	.4921	3640721	B291A12500YPL	14	107	60	43	2,4	45	●
	12,700	1/2	.5000	3640722	B291A12700YPL	14	107	60	43	2,4	45	●
	13,000	—	.5118	3640723	B291A13000YPL	14	107	60	43	2,5	45	●
	14,000	—	.5512	3640724	B291A14000YPL	14	107	60	43	2,7	45	●
	14,500	—	.5709	3640725	B291A14500YPL	16	115	65	45	2,8	48	●
NÁSTROJOVÉ SYSTÉMY	15,000	—	.5906	3640726	B291A15000YPL	16	115	65	45	2,8	48	●
	16,000	—	.6299	3640727	B291A16000YPL	16	115	65	45	3,0	48	●
	17,000	—	.6693	3640728	B291A17000YPL	18	123	73	51	3,2	48	●
	18,000	—	.7087	3640729	B291A18000YPL	18	123	73	5			

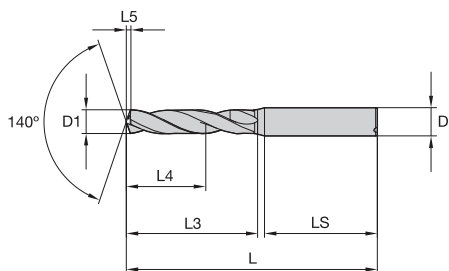

SLUŽBY

SOUSTRUŽENÍ

VRTÁNÍ

FRÉZOVACÍ
NÁSTROJE

KARBIDOVÉ
STOPKOVÉ FRÉZY

NÁSTROJOVÉ
SYSTEMY

REJSTŘÍK

■ B292_YPL

- První volba
- náhradní volba

H		
S		
N		
K		
M		
P		

D1												
mm	palce	palce	Objednací číslo	Katalogové číslo	D	L	L3	L4 max	L5	LS	KC7315	
3,000	—	.1181	3640730	B292A03000YPL	6	66	28	23	0,6	36	●	
3,170	—	.1248	3640731	B292A03175YPL	6	66	28	23	0,6	36	●	
3,500	—	.1378	3640732	B292A03500YPL	6	66	28	23	0,7	36	●	
4,000	—	.1575	3640743	B292A04000YPL	6	74	36	29	0,8	36	●	
4,200	—	.1654	3640744	B292A04200YPL	6	74	36	29	0,8	36	●	
4,300	—	.1693	3640745	B292A04300YPL	6	74	36	29	0,8	36	●	
4,500	—	.1772	3640746	B292A04500YPL	6	74	36	29	0,9	36	●	
4,800	—	.1890	3640747	B292A04800YPL	6	82	44	35	0,9	36	●	
5,000	—	.1969	3640748	B292A05000YPL	6	82	44	35	1,0	36	●	
5,100	—	.2008	3640749	B292A05100YPL	6	82	44	35	1,0	36	●	
5,200	—	.2047	3640750	B292A05200YPL	6	82	44	35	1,0	36	●	
5,410	—	.2130	3640751	B292A05410YPL	6	82	44	35	1,1	36	●	
5,500	—	.2165	3640752	B292A05500YPL	6	82	44	35	1,1	36	●	
5,550	—	.2185	3640753	B292A05558YPL	6	82	44	35	1,1	36	●	
5,600	—	.2205	3640754	B292A05600YPL	6	82	44	35	1,1	36	●	
5,800	—	.2283	3640755	B292A05800YPL	6	82	44	35	1,1	36	●	
6,000	—	.2362	3640756	B292A06000YPL	6	82	44	35	1,2	36	●	
6,350	1/4	.2500	3640757	B292A06350YPL	8	91	53	43	1,2	36	●	
6,500	—	.2559	3640758	B292A06500YPL	8	91	53	43	1,3	36	●	
6,520	—	.2567	3640759	B292A06528YPL	8	91	53	43	1,3	36	●	
6,740	—	.2654	3640760	B292A06746YPL	8	91	53	43	1,3	36	●	
6,800	—	.2677	3640761	B292A06800YPL	8	91	53	43	1,3	36	●	
6,900	—	.2717	3640762	B292A06900YPL	8	91	53	43	1,3	36	●	
7,000	—	.2756	3640763	B292A07000YPL	8	91	53	43	1,4	36	●	
7,100	—	.2795	3640764	B292A07100YPL	8	91	53	43	1,4	36	●	
7,140	—	.2811	3640765	B292A07145YPL	8	91	53	43	1,4	36	●	
7,200	—	.2835	3668058	B292A07200YPL	8	91	53	43	1,4	36	●	
7,500	—	.2953	3640766	B292A07500YPL	8	91	53	43	1,4	36	●	
7,930	—	.3122	3640767	B292A07938YPL	8	91	53	43	1,5	36	●	
8,000	—	.3150	3640768	B292A08000YPL	8	91	53	43	1,5	36	●	
8,330	—	.3280	3640769	B292A08334YPL	10	103	61	49	1,6	40	●	
8,430	—	.3319	3640770	B292A08433YPL	10	103	61	49	1,6	40	●	
8,500	—	.3346	3640771	B292A08500YPL	10	103	61	49	1,6	40	●	
8,730	—	.3437	3640772	B292A08733YPL	1							

