

# HS6 SERIES ELECTRICAL TOOL SWITCH

up to 12(8)A 250VAC



HS6-2-A-E-Z1



HS6-2-A-G-Z1



HS6-2-B-H-Z3

12(8)A

250VAC

5E4



HS6 - 2 - A - E - Z1  
 SERIES NO.2 FUNCTION BUTTON LOCK BUTTON

## DIMENSIONS(mm)

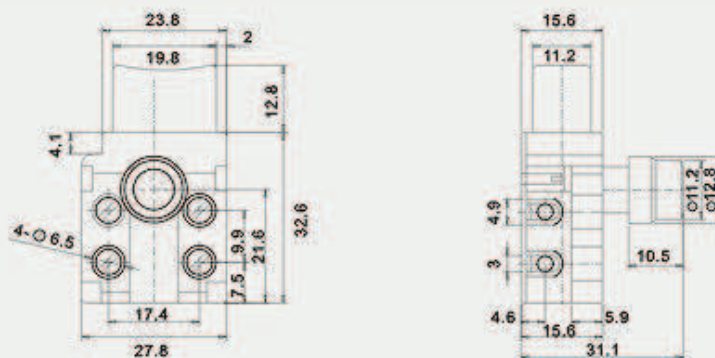

## FUNCTION

## BUTTON

## LOCK BUTTON

A NO-LOCK

E



19.8×11.2×12.8

F



30.7×11.2×22

G



44.5×11.2×17

H



57.9×14×20

Z1 NO LOCK

Z2



$\varnothing 12.8 \times 10.5$

Z3



$\varnothing 11.3 \times 9.8$